

3-3/0 THHN
1-#4 THHN

2" PVC

2" PVC

3-3/0 THHN
1-#4 THHN



200 AMP
ATS

3-3/0 THHN
1-#4 THHN
6-#14 THHN

1 1/4" PVC
BURIED
18"

1 1/4" GAS
VENT
18" DEEP

GENERATOR

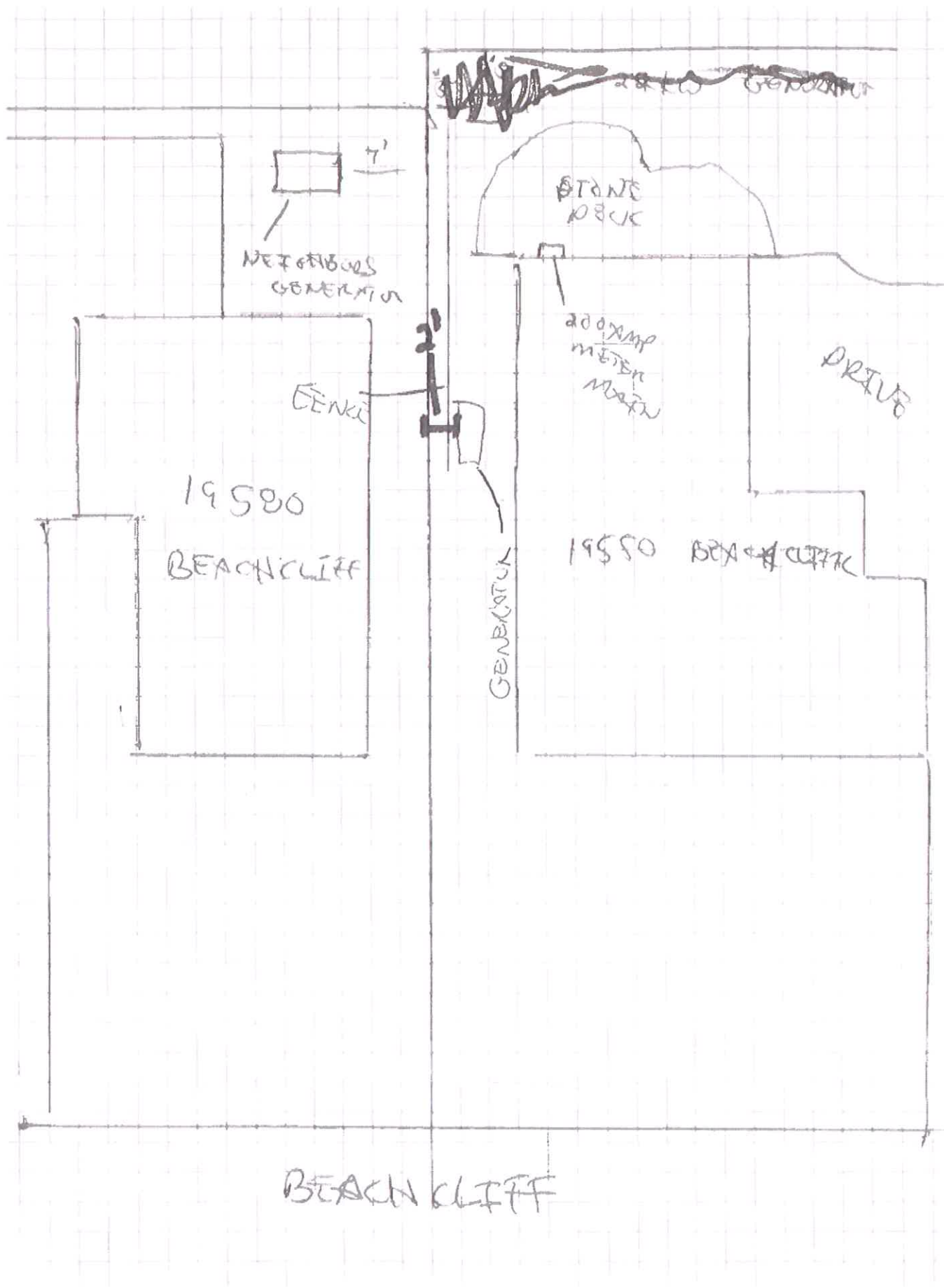

~~GENERATOR~~

STONE
DECK

200 AMP
METER
MAIN

DRIVE

7'

NETS/BUS
GENERATOR

FENCE

19580
BEACHCLIFF

GENERATOR

19550 BEACHCLIFF

BEACH CLIFF

NETS WOLF'S GENERATION

GENERAL
OPTION

19550

BBACMLZFT





GENERAC®

20/22/24 kW

20/22/24 kW

GUARDIAN® SERIES Residential Standby Generators Air-Cooled Gas Engine

1 of 1

INCLUDES:

- True Power™ Electrical Technology
- Two-line multilingual digital LCD Evolution™ controller (English/Spanish/French/Portuguese)
- 200 amp service rated transfer switch available
- Electronic governor
- Standard Wi-Fi® connectivity
- System status & maintenance interval LED indicators
- Sound attenuated enclosure
- Flexible fuel line connector
- Natural gas or LP gas operation
- 5 Year limited warranty
- Listed and labeled for installation as close as 18 in (457 mm) to a structure.*

**Must be located away from doors, windows, and fresh air intakes and in accordance with local codes.*

Standby Power Rating

G007038-1, G007039-1, G007038-3, G007039-3 (Aluminum - Bisque) - 20 kW 60 Hz
G007042-10, G007042-11, G007043-10, G007043-11 (Aluminum - Bisque) - 22 kW 60 Hz
G007209-10, G007210-10 (Aluminum - Bisque) - 24 kW 60 Hz



Product shown with optional fascia kit



QUIET-TEST™



Note: CETL or CUL certification only applies to unbundled units and units packaged with limited circuit switches. Units packaged with the Smart Switch are ETL or UL certified in the USA only.

FEATURES

- **INNOVATIVE ENGINE DESIGN & RIGOROUS TESTING** are at the heart of Generac's success in providing the most reliable generators possible. Generac's G-Force engine lineup offers added peace of mind and reliability for when it's needed the most. The G-Force series engines are purpose built and designed to handle the rigors of extended run times in high temperatures and extreme operating conditions.
- **TRUE POWER™ ELECTRICAL TECHNOLOGY:** Superior harmonics and sine wave form produce less than 5% Total Harmonic Distortion for utility quality power. This allows confident operation of sensitive electronic equipment and micro-chip based appliances, such as variable speed HVAC systems.
- **TEST CRITERIA:**
 - ✓ **PROTOTYPE TESTED**
 - ✓ **SYSTEM TORSIONAL TESTED**
 - ✓ **NEMA MG1-22 EVALUATION**
 - ✓ **MOTOR STARTING ABILITY**
- **MOBILE LINK® CONNECTIVITY:** FREE with select Guardian Series Home standby generators, Mobile Link Wi-Fi allows users to monitor generator status from anywhere in the world using a smartphone, tablet, or PC. Easily access information such as the current operating status and maintenance alerts. Users can connect an account to an authorized service dealer for fast, friendly, and proactive service. With Mobile Link, users are taken care of before the next power outage.
- **SOLID-STATE, FREQUENCY COMPENSATED VOLTAGE REGULATION:** This state-of-the-art power maximizing regulation system is standard on all Generac models. It provides optimized FAST RESPONSE to changing load conditions and MAXIMUM MOTOR STARTING CAPABILITY by electronically torque-matching the surge loads to the engine. Digital voltage regulation at $\pm 1\%$.
- **SINGLE SOURCE SERVICE RESPONSE** from Generac's extensive dealer network provides parts and service know-how for the entire unit, from the engine to the smallest electronic component.
- **GENERAC TRANSFER SWITCHES:** Long life and reliability are synonymous with GENERAC POWER SYSTEMS. One reason for this confidence is that the GENERAC product line is offered with its own transfer systems and controls for total system compatibility.

THE GENERAC
PROMISE



*Assembled in the USA using domestic and foreign parts.

20/22/24 kW

Features and Benefits

Installation System

- 14 in (35.6 cm) flexible fuel line connector
- Integral sediment trap

Listed ANSI Z21.75/CSA 6.27 outdoor appliance connector for the required connection to the gas supply piping.
Meets IFGC and NFPA 54 installation requirements.

Connectivity (Wi-Fi equipped models only)

- Ability to view generator status
- Ability to view generator Exercise/Run and Total Hours
- Ability to view generator maintenance information
- Monthly report with previous month's activity
- Ability to view generator battery information
- Weather information

Monitor generator with a smartphone, tablet, or computer at any time via the Mobile Link application for complete peace of mind.
Review the generator's complete protection profile for exercise hours and total hours.
Provides maintenance information for the specific model generator when scheduled maintenance is due.
Detailed monthly reports provide historical generator information.
Built in battery diagnostics displaying current state of the battery.
Provides detailed local ambient weather conditions for generator location.

20/22/24 kW

Service Rated Automatic Transfer Switch Features

- Intelligently manages up to four air conditioner loads with no additional hardware.
- Up to eight additional large (240 VAC) loads can be managed when used in conjunction with Smart Management Modules (SMMs).
- Electrically operated, mechanically-held contacts for fast, clean connections.
- Main breakers are rated for 80% continuous load.
- 2-pole, 250 VAC contactors.
- Service equipment rated, dual coil design.
- Rated for both aluminum and copper conductors.
- Main contacts are silver plated or silver alloy to resist welding and sticking.
- NEMA/UL 3R aluminum outdoor enclosure allows for indoor or outdoor mounting flexibility.

Dimensions

| 200 Amps 120/240, 1Ø Open Transition Service Rated | | | | | |
|---|--------|-------|-------|-------|-------|
| | Height | | Width | | Depth |
| | H1 | H2 | W1 | W2 | |
| in | 26.8 | 30.1 | 10.5 | 13.5 | 6.9 |
| cm | 67.95 | 76.43 | 26.67 | 34.18 | 17.5 |

| Wire Ranges | | |
|---------------|--------------|------------|
| Conductor Lug | Neutral Lug | Ground Lug |
| 250 MCM - #6 | 350 MCM - #6 | 2/0 - #14 |

Model

G007039-1, G007039-3 (20 kW)
G007043-10, G007043-11 (22 kW)
G007210-10 (24 kW)

| | |
|----------------------------------|----------------|
| No. of poles | 2 |
| Current rating (amps) | 200 |
| Voltage rating (VAC) | 120/240, 1Ø |
| Utility voltage monitor (fixed)* | |
| -Pick-up | 80% |
| -Dropout | 65% |
| Return to Utility* | Approx. 13 sec |
| ETL or UL listed | Standard |
| Enclosure type | NEMA/UL 3R |
| Circuit breaker protected | 22,000 |
| Lug range | 250 MCM - #6 |

*Function of Evolution controller

Exercise can be set to weekly, bi-weekly, or monthly

