



FUNSHI GROUP LLC  
21605 CENTER RIDGE RD,  
ROCKY RIVER, OH 44116

## SIGNAGE PROPOSAL

PROJECT NUMBER: P70558  
DATE CREATED: 01.01.2025

LEGEND

	QTY
1 NORTH ELEVATION WALL SIGN	1

KEY

SIGN LOCATION

BUILDING OUTLINE

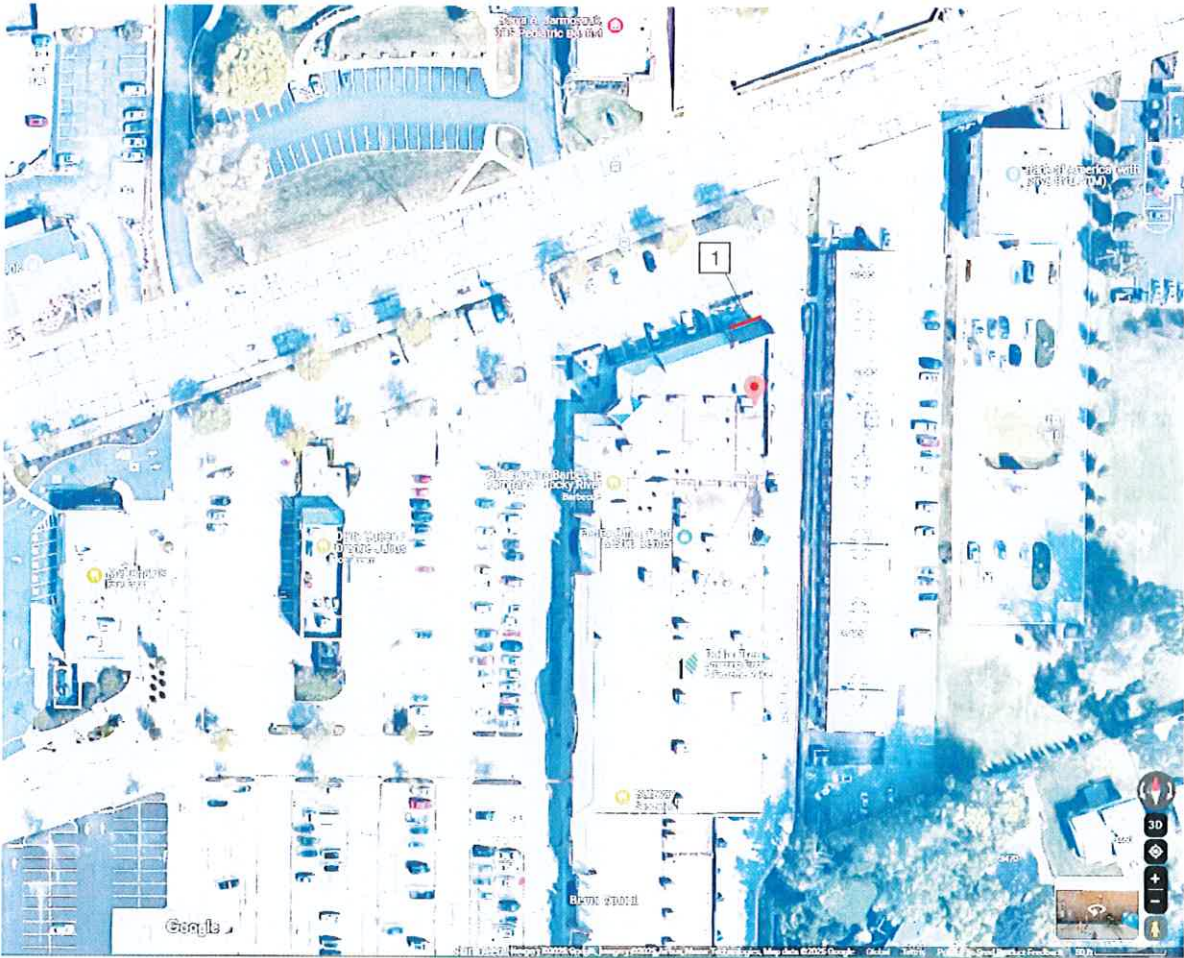

 **BLINKSIGNS**

1925 St. Clair Ave NE  
Cleveland, OH 44114  
(877) 433-4466  
(216) 593-2568  
www.blinksigns.com

This document and its contents are the exclusive intellectual property of Blink Signs. This document contains confidential and proprietary information and cannot be disclosed or reproduced in whole or part without expressed written authorization from Blink Signs. Unauthorized use of information derived from this document is strictly forbidden and will be subject to U.S. and International copyright laws. Design information contained herein is "design-intent" only and is not suitable for production purposes. Copyright © 2018 Blink Signs. All rights reserved.

DESIGNER
Hassan Mahmood
PROSPECT CLIENT
Funshi Group LLC
PROJECT NUMBER
P70558
PROJECT
Exterior Signage
PROJECT MANAGER
Sam Khan
SALES REP
Patrick Setele
PROJECT LOCATION
21605 Center Ridge Rd, Rocky River, OH 44116
DATE CREATED
01.01.2025
PAGE
2

REVISIONS
DATE:
DATE:
DATE:

WE ARE NOT DOING MANUFACTURING, INSTALLATION ONLY



BEFORE



AFTER

SHEET TITLE	QTY
SIGN 1: FRONT-LIT CHANNEL LETTERS - RENDERING	1

**BLINKSIGNS**  
1905 St Clair Ave NE  
Cleveland, OH 44114  
(877) 433-4566  
(216) 503-2568  
www.blinksigns.com

This document and its contents are the exclusive intellectual property of Blink Signs. This document contains confidential and proprietary information and cannot be disclosed or reproduced in whole or part, without expressed written authorization from Blink Signs. Unauthorized use of information derived from this document is strictly forbidden and will be subject to U.S. and International copyright laws. Design information contained herein is "design-intent" only and is not suitable for production purposes. Copyright © 2018 Blink Signs. All rights reserved.

DESIGNER
Hassan Mehmood
PROSPECT CLIENT
Funshi Group LLC
PROJECT NUMBER
P70558
PROJECT
Exterior Signage
PROJECT MANAGER
Sam Khan
SALES REP
Patrick Setele
PROJECT LOCATION
21605 Center Ridge Rd, Rocky River, OH 44116
DATE CREATED
01.01.2025
PAGE
3
REVISIONS
DATE:
DATE:
DATE:



WE ARE NOT DOING MANUFACTURING, INSTALLATION ONLY

SCOPE:  
- INSTALLATION ONLY

City Code:  
- 40% of signable area  
- Total width of sign band= 26.25 FT (315")  
- Total height of sign band = 60.2"  
315 x 60.2 / 144 = 131.6875  
- 40% of 131.6875 = 52.675 sf



1. All signs shall have concealed attachment devices, clips, wiring, transformers, lamps, tubes and ballast. All signs must be underwriter approved.
2. Sign letters shall be individual raised letters with a fixed depth of five inches (5").
3. **FUNSHI** Material: High-transparency acrylic.  
Color Code: Orange-Red (Pantone 172)   
Illumination Method: Backlit illumination with a light source using 6000K white LED lights  
letters will be mounted on raceways. All raceway housings and faces shall be painted Matthews dark bronze.  
**Sushi Ramen Boba tea** Material: Aluminum side panels + high-transparency acrylic.  
Color: White Illumination.  
Method: Backlit illumination with a light source using 6000K white LED lights.
4. All transformers shall be completely self-contained within each individual letter housing. The maximum size of electrical wire/conduit penetrations of the brick building facade shall not exceed 5/8".

SURVEY REQUIRED



SHEET TITLE	QTY
SIGN 1: FRONT-LIT CHANNEL LETTERS - FABRICATION DETAILS	1

**BLINKSIGNS**  
1925 St Clair Ave NE  
Cleveland, OH 44114  
(877) 423-4466  
(216) 503-2569  
www.blinksigns.com

This document and its contents are the exclusive intellectual property of Blink Signs. This document contains confidential and proprietary information and cannot be disclosed or reproduced in whole or part without expressed written authorization from Blink Signs. Unauthorized use of information derived from this document is strictly forbidden and will be subject to U.S. and international copyright laws. Design information contained herein is "design-intent" only and is not suitable for production purposes. Copyright © 2018 Blink Signs. All rights reserved.

DESIGNER  
Hassan Mahmood

PROSPECT CLIENT  
Funshi Group LLC

PROJECT NUMBER  
P70558

PROJECT  
Exterior Signage

PROJECT MANAGER  
Sam Khan

SALES REP  
Patrick Setele

PROJECT LOCATION  
21605 Center Ridge Rd,  
Rocky River, OH 44116

DATE CREATED  
01.01.2025

PAGE  
4

REVISIONS
DATE:
DATE:
DATE: