



Specializing in Sheds,
Garages,
Kennels,
Gazebos,
Onsite Builds

New Order

2226 McMyler St. NW
Warren, Ohio 44485
330-979-3146
steelcitysheds@gmail.com

Date: 3-2-26
Approx. Del. Date: 2 wks
Dealer: Jayne

- Order - Shop Built New on Lot
 Model on Lot Repo

01 Building Style & Size

Size: 8x10 Lofted Slant
 Utility

02 Exterior Options

Exterior Siding

- Utility
Color: _____

 Lofted
 Stained Painted
Color: _____

Roofing Type

- Metal - Standard
 Shingles
Color: _____

Trim Color
Color: _____
Doors On
 End Side

Notes:

04 Delivery Information

Name: Haley DeLeon
Delivery Address: _____
City: _____ State: _____ Zip: _____
Primary Phone: _____
Secondary Phone: _____
Email: _____

All Sizes Nominal, 8' Wall Height Measured on Outside, 12' and 14' wide measured eave to eave, 5/8" LP Flooring is Standard

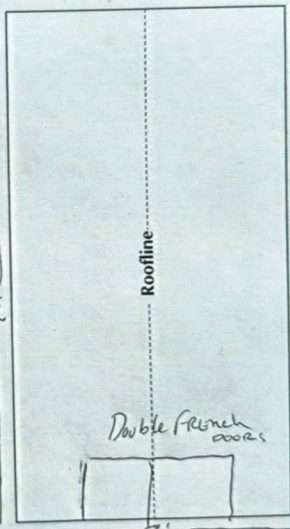

By signing below customer has stated Design is Acceptable

Customer Signature _____

Customer understands all C.O.D. Checks to be payable to Steel City Sheds, or transaction is void, stock fee to be paid to shipper in cash upon delivery.

Shed Price \$ _____ Payment Type: Cash RTO
Options Price \$ _____ 90 days SAC Finance
Total Pre Tax \$ _____
Rate Sales Tax \$ _____ Down Payment _____
Total \$ _____ Balance Due _____ Upon Delivery if Cash
Dlrvy. over 100 miles \$ _____
Total \$ _____

Steel City Sheds, and its associates are not responsible for permits, covenant searches, restrictions, set backs, yard damage, or underground damage.
Cancellation, Partial Refund/Restocking Fee: Orders for standard portable building(s) may be cancelled by purchaser if any time before the building is built. If purchaser cancels such an order, Seller will charge the purchaser a restocking fee equal to 25% of the purchase price shown on the first page of this order (The Restocking Fee). Such restocking fee will (1) be retained by Seller if purchaser has paid all of the purchase price or a portion of the purchase price equaling, or exceeding 25% of the purchase price at the time of cancellation, provided that Seller will refund to purchaser all amounts in excess of the Restocking Fee, or (2) be immediately due and owing by purchaser to Seller at the time of cancellation, provided that Seller will refund to purchaser all amounts in excess of the Restocking Fee any amounts then 25% of the purchase price, provided that Seller may apply against such Restocking Fee any amounts then paid by purchaser. Order for custom built or custom painted portable building(s) may not be cancelled except with prior written consent of the Seller, which consent may withhold for any reason or no reason. The remaining balance of the 25% restocking fee, assuming the full amount was not yet collected at time of sale, must be made in order for a cancellation of the contract to occur. Additionally, once the custom and contracted building has been built, Steel City Sheds reserves the right to advise the cancellation process and the purchaser is responsible for payment in full. Additionally, ALL REFUNDING GIVEN will require 3-5 weeks processing time of other requirements are met.
*Non-Refundable Fee will be charged on Cancels of Orders (25% on Cash Sales or Security Deposit on RTO orders). Cash on Delivery (COD) down-payments are non-refundable if

